

166773
325-3000

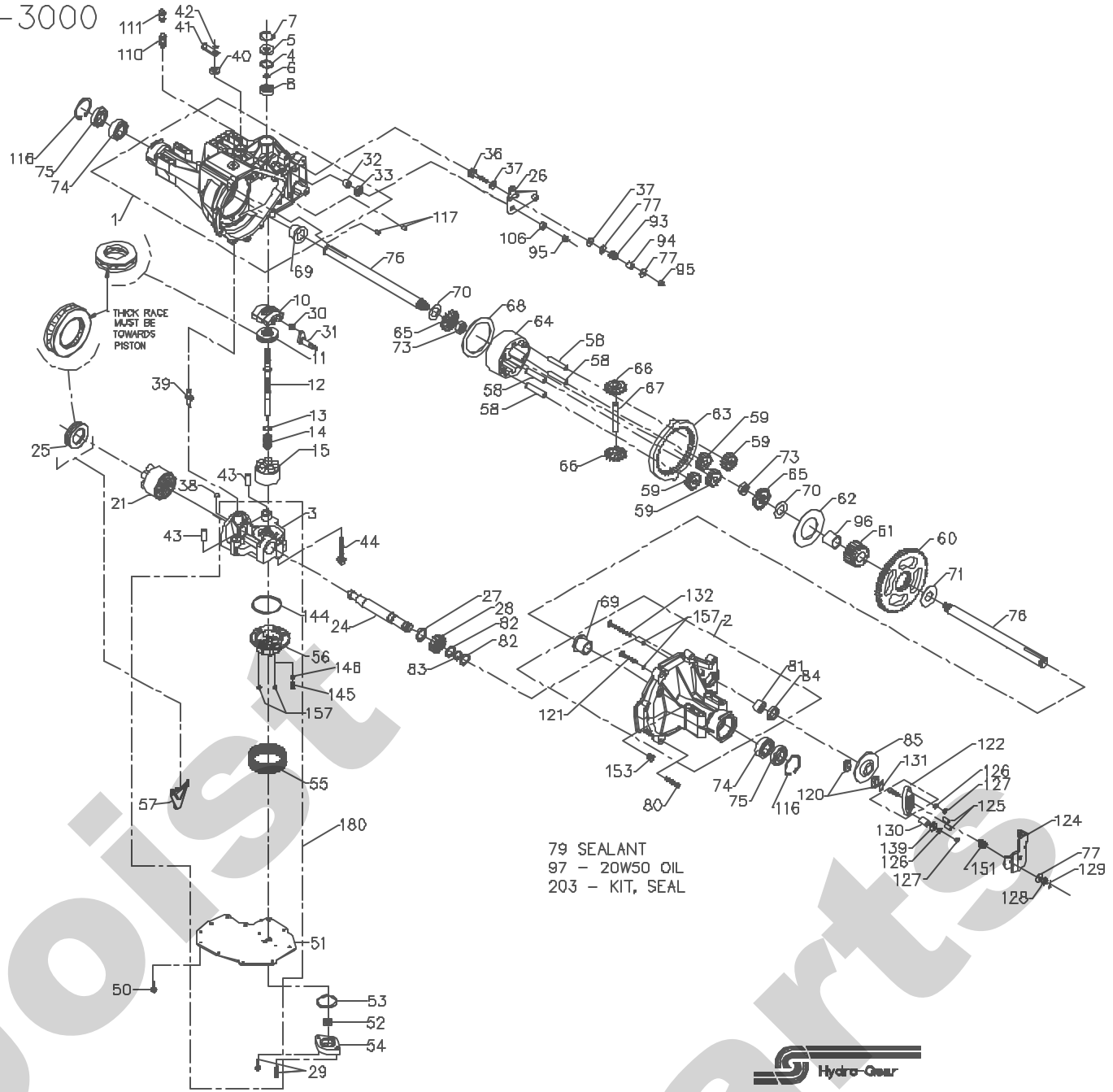

P.1 of 2. 70410-S4

166773
325-3000

ITEM #	PART #	QTY	DESCRIPTION	ITEM #	PART #	QTY	DESCRIPTION	ITEM #	PART #	QTY	DESCRIPTION
1	70297	1	HOUSING, MAIN ASSEMBLY	50	50752	11	SCREW 1/4-20X 75	131	44134	1	PLATE, PUCK
		1	HOUSING, MAIN	51	50972	1	COVER, LOWER	132	50865	1	BOLT, 3" RIB NECK
		1	SEAL, LIP 12x25x7	52	50273	1	GEROTOR ASSEMBLY	139	44278	1	WASHER .875X.265X.125
		1	BEARING, FLANGE	53	9004101-1340	1	O-RING .1D3X1.862	144	50974	1	O RING .1D3X2.987
		2	CRADLE BEARING	54	50260	1	GEROTOR COVER	145	51157	1	SPRING, RELIEF
2	70298	1	BUSHING, TRUNNION	55	70538	1	KIT, FILTER	146	9001214-4400	1	BALL 7/16
		1	HOUSING, R.H ASSEMBLY			2	GASKET .10X 16X4 24	151	50919	1	SPRING, COMP BRAKE ANTI-DRAW
		1	HOUSING, R.H			1	FILTER	153	9005110-5600	1	PLUG, STRAIGHT THREAD
		1	BEARING, FLANGE	56	51156	1	MANIFOLD, CHARGE	157	50977	4	O-RING .07DX.239
		2	O-RING .07DX.239	57	50796	1	RETAINER, MOTOR BEARING	180	70449	1	KIT, MANIFOLD
		1	BOLT, 2" RIB NECK	58	50776	4	PIN, CARRIER			1	CENTER SECTION
		1	BOLT, 3" RIB NECK	59	50763	4	GEAR, 1ST PLANET			2	CAPSCREW M6X1-22
		1	BEARING, NEEDLE .875X1.125X.750	60	50846	1	GEAR, 67T SPUR			1	COVER, LOWER
		1	SEAL, LIP .875X1.375X.250	61	50845	1	GEAR, 21 TOOTH SUN			1	KIT, FILTER
3	70438	1	KIT, CENTER SECTION	62	50769	1	PLATE, PLANET THRUST			1	MANIFOLD, CHARGE
		1	CENTER SECTION	63	50764	1	GEAR, 51T RING			1	RETAINER, MOTOR BEARING
		1	BUSHING .50x.595x.50	64	50765	1	CARRIER, PLANETARY			1	O RING .103X2.987
		1	BUSHING .90x1.02x .75	65	50647	2	GEAR, MITER DIFF. (SPUNED)			1	SPRING, RELIEF
		1	CHECK PLUG ASSEMBLY, NO BLEED	66	50848	2	GEAR, MITER DIFF.			1	BALL 7/16
		1	CHECK PLUG ASSEMBLY, .044 BLEED	67	50766	1	SHAFT, DIFFERENTIAL			2	O-RING .07DX.239
		1	SPAGER	68	50767	1	PLATE, DIFF. THRUST			1	KIT, SEAL
4	2003018	1	SEAL, LIP 15X35X7	69	50768	2	BEARING, FLANGE				
5	9008000-0128	1	RING, WIRE RETAINING	70	50770	2	WASHER 1.0X1.75X.04				
6	2003016	1	RING, RETAINING	71	50788	1	WASHER 1.0X2.25X.04				
7	2003052	1	BEARING, BALL 15X35X11	73	50791	2	NUT, HEX JAM 5/8-18				
8	2003043	1	SWASHPLATE, VARIABLE	74	50771	2	BEARING, BALL 25.4X52X15				
10	2003087	1	BEARING, THRUST 30X52X13	75	50772	2	SEAL 1.000X2.049X.375				
11	50551	1	SHAFT, INPUT	76	50663	2	SHAFT, AXLE				
12	50795	1	WASHER, BLOCK THRUST	77	44130	3	WASHER .34X.88X.06				
13	2003017	1	SPRING, BLOCK	79	50928	1	SEALANT				
14	2003014	1	BLOCK, 1Dcc CYLINDER ASSEMBLY	80	50868	9	SCREW, TORX HEAD 5/16-18				
15	70331	1	BLOCK, 1Dcc CYLINDER	81	44752	1	BEARING, NEEDLE .875X1.125X.750				
		5	PISTON, 10cc	82	50777	2	WASHER .88X1.25X.04				
		5	SPRING, 10cc PISTON	83	50775	1	RING, RETAINING				
		5	WASHER, PISTON SEAT	84	50773	1	SEAL, LIP .875X1.30X.25				
21	70082	1	BLOCK, 21cc CYLINDER ASSEMBLY	85	50778	1	DISK, BRAKE				
		1	BLOCK, 21cc CYLINDER	93	50277	1	SPRING, FRICTION PACK				
		7	WASHER, PISTON SEAT	94	50278	1	SPACER, FRICTION PACK				
		7	PISTON, 21cc	95	50108	2	NUT, HEX LOCK 5/16-24				
		7	SPRING, 21cc PISTON	96	50866	1	BEARING, SLEEVE 1.0X1.31X1.34				
		1	SHAFT, MOTOR	97		1	OIL-20W50				
24	50662	1	BEARING, THRUST 42X68X16	106	50850	1	SPACER, TRUNNION				
25	50552	1	ARM, CONTROL	110	70110	1	FITTING, O-RING ASS'Y				
26	50857	1	SPACER			1	FITTING, PLASTIC HOSE				
27	50774	1	GEAR, 18T PINION			1	O-RING				
28	50661	1	CAPSCREW, M6X1-22	111	70109	1	VENT, CAP ASS'Y				
29	50975	2	GUIDE, SLOT			1	VENT, PLASTIC				
30	2000015	1	ARM, TRUNNION			1	VENT, CAP				
31	50807	1	BUSHING, TRUNNION	116	50859	2	RING, RETAINING				
32	2003008	1	SEAL, LIP 12X25X7	117	9004800-2506	2	PIN, STD HDLS				
33	9008000-0126	1	STUD 5/16-24	120	44132	2	PUCK, BRAKE				
36	50284	1	PUCK, FRICTION	121	50874	1	BOLT, 2" RIB NECK				
37	50281	2	PLATE, BYPASS	122	70633	1	YOKE, BRAKE ASSEMBLY				
38	2003554	1	ACTUATOR, BYPASS	124	50916	1	ARM, BRAKE				
39	2003555	1	SEAL, LIP 10X25X7	125	44127	2	PINS, BRAKE				
40	45074	1	ARM, BYPASS	126	43177	2	LOCKWASHER 1/4"				
41	50270	1	RING, RETAINING	127	43178	2	NUT 1/4-20				
42	44870	1	PIN	128	44142	1	NUT, CASTLE				
43	50002	2	SCREW 3/8-24X2.5	129	44101	1	PIN, COTTER				
44	50016	3		130	23711	1	SPACER				

Hydro-Gear

P.2 of 2 70410-S4