

317-2400R

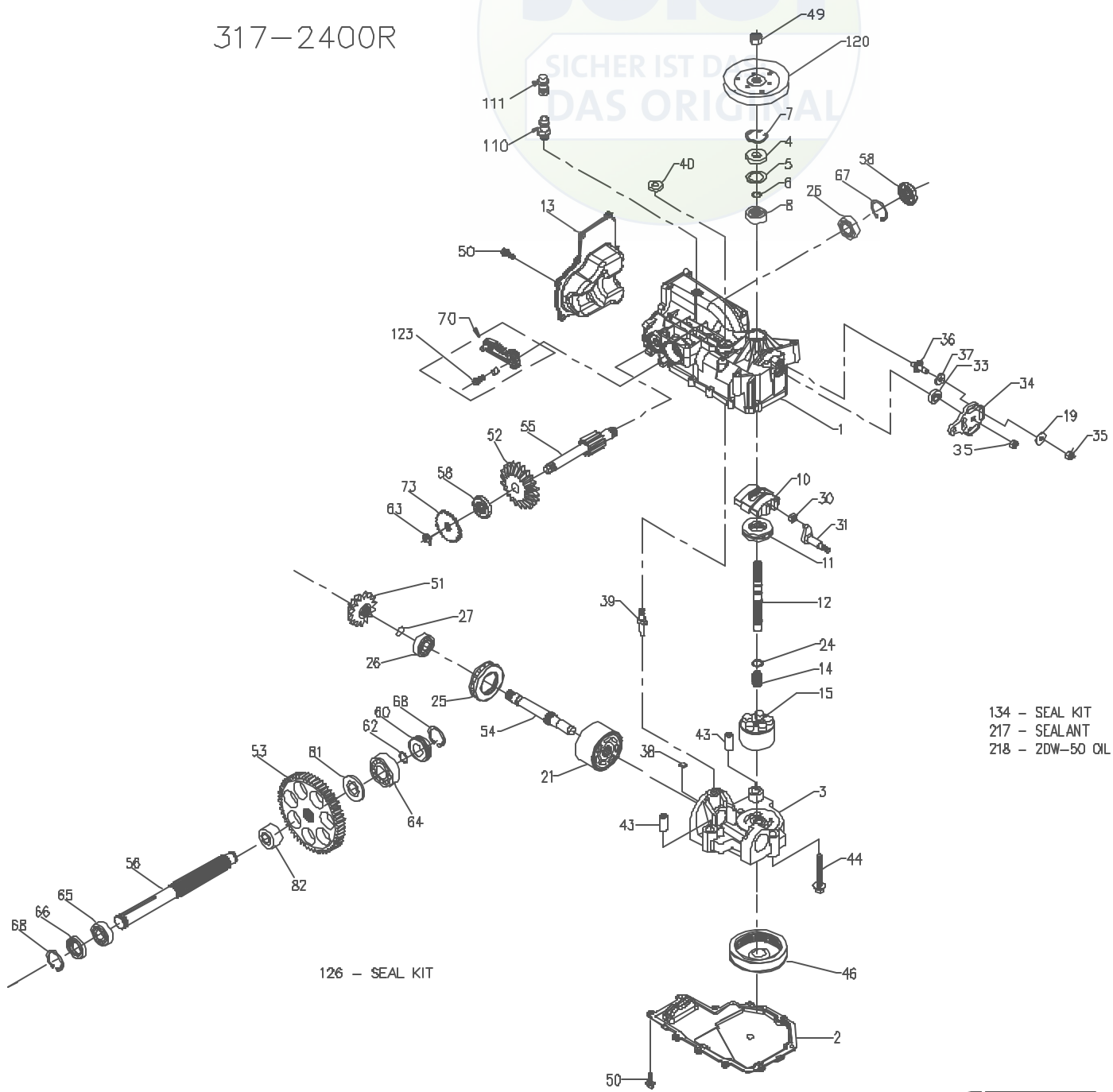

317-2400R

| ITEM # | PART # | QTY | DESCRIPTION |
|--------|--------------|-----|-----------------------------|
| 1 | 70329 | 1 | UPPER HOUSING ASSEMBLY |
| | | 1 | UPPER HOUSING |
| | | 2 | CRADLE BEARING |
| | | 1 | TRUNNION BUSHING |
| | | 1 | LIP SEAL |
| 2 | 50890RM | 1 | LOWER HOUSING |
| 3 | 70552 | 1 | CENTER SECTION ASSEMBLY KIT |
| | | 1 | BYPASS PLATE |
| | | 2 | CHECK PLUG ASSEMBLY |
| | | 1 | CENTER SECTION |
| | | 1 | BUSHING |
| | | 3 | BOLT, 3/8-24 X 2.5 |
| 4 | 9008000-012B | 1 | LIP SEAL |
| 5 | 2003018 | 1 | SPACER |
| 6 | 2003016 | 1 | WIRE RETAINING RING |
| 7 | 2003052 | 1 | RETAINING RING |
| 8 | 2003043 | 1 | BALL BEARING |
| 10 | 2003087 | 1 | VARIABLE SWASHPLATE |
| 11 | 50551 | 1 | THRUST BEARING 30 X 52 X 13 |
| 12 | 50005 | 1 | INPUT SHAFT |
| 13 | 50891RM | 1 | COVER-BACK |
| 14 | 2003014 | 1 | SPRING, BLOCK |
| 15 | 70331 | 1 | 10cc CYLINDER BLOCK ASS'Y |
| | | 1 | 10cc CYLINDER BLOCK |
| | | 5 | 10cc PISTON SPRING |
| | | 5 | PISTON SEAT WASHER |
| | | 5 | 10cc PISTON |
| 19 | 44130 | 1 | WASHER |
| 21 | 70082 | 1 | 21cc CYLINDER BLOCK ASS'Y |
| | | 1 | 21cc CYLINDER BLOCK |
| | | 7 | 21cc PISTON SPRING |
| | | 7 | PISTON SEAT WASHER |
| | | 7 | 10cc PISTON |
| 24 | 2003017 | 1 | WASHER, BLOCK THRUST |
| 25 | 50552 | 1 | THRUST BEARING 42 X 68 X 16 |
| 26 | 50315 | 2 | BALL BEARING |
| 27 | 2000022 | 1 | WIRE RETAINING RING |
| 30 | 2000015 | 1 | SLOT GUIDE |
| 31 | 50807 | 1 | TRUNNION ARM |
| 33 | 9008000-012B | 1 | LIP SEAL |
| 34 | 50749 | 1 | CONTROL ARM |
| 35 | 50317 | 2 | NUT |
| 36 | 50426 | 1 | STUD - SHORT 5/16-24 |
| 37 | 50281 | 1 | FRICTION PUCK |
| 38 | 2003554 | 1 | BYPASS PLATE |
| 39 | 2003555 | 1 | BYPASS ACTUATOR |
| 40 | 45074 | 1 | LIP SEAL |
| 43 | 50002 | 2 | PIN |
| 44 | 50016 | 3 | SCREW |
| 46 | 5099D | 1 | FILTER |
| 49 | 44133 | 1 | NUT-HEX HEAD JAM 1/2-20 |

| ITEM # | PART # | QTY | DESCRIPTION |
|--------|---------|------|-------------------------------------|
| 50 | 50752 | 18 | SCREW, 1/4-20 X .75 LONG |
| 51 | 50744 | 1 | 14T BEVEL GEAR |
| 52 | 50745 | 1 | 19T BEVEL GEAR |
| 53 | 50746 | 1 | 53T SPUR GEAR |
| 54 | 50757 | 1 | MOTOR SHAFT |
| 55 | 70393 | 1 | BRAKE SHAFT KIT |
| | | 1 | RETAINING RING 0.440 EXTERNAL |
| 56 | 51329 | 1 | AXLE SHAFT |
| 58 | 50735 | 2 | SEAL, LIP 17 X 40 X 5 |
| 60 | 50995 | 1 | SEAL PLUG - SIDE |
| 62 | 50759 | 1 | RETAINING RING - AXLE |
| 63 | 70396 | 1 | RETAINING RING KIT |
| 64 | 50743 | 1 | BEARING-BALL 20X47X14(6204) |
| 65 | 50740 | 1 | BEARING-BALL 25X47X12(6005) |
| 66 | 50751 | 1 | SEAL |
| 67 | 50329 | 1 | RETAINING RING |
| 68 | 50760 | 2 | RETAINING RING-AXLE |
| 70 | 70391 | 1 | LH BRAKE ARM SERVICE ASSEMBLY |
| | | 1 | BRAKE ARM |
| | | 1 | CLEVIS PIN |
| | | 1 | BUSHING 0.255X0.381X0.330 |
| | | 1 | HEX WASHER HEAD SCREW, 1/4-20 X 7/8 |
| 73 | 50754 | 1 | BRAKE DISC |
| 81 | 50942-2 | 1 | AXLE BUSHING |
| 82 | 50942-1 | 1 | AXLE BUSHING |
| 95 | 50217 | 1 | PLASTIC VENT |
| 96 | 50216 | 1 | CAP-POPPET VALVE |
| 97 | 50218 | 1 | O-RING |
| 98 | 50219 | 1 | PLASTIC HOSE FITTING |
| 110 | 70110 | 1 | FITTING O-RING ASSEMBLY |
| | | 1 | PLASTIC HOSE FITTING |
| | | 1 | O-RING |
| 111 | 70109 | 1 | CAP VENT ASSEMBLY |
| | | 1 | CAP-POPPET VALVE |
| | | 1 | PLASTIC VENT |
| 120 | 51182 | 1 | PULLEY, 45 |
| 123 | 51076 | 1 | HEX WASHER HEAD SCREW, 1/4-20 X 7/8 |
| 134 | 70553 | 1 | KIT, SEAL |
| | | 1 | SEAL, LIP 15X35X7 PTC |
| | | 1 | RING, RETAINING |
| | | 1 | SEAL, LIP 12X25X7 |
| | | 1 | SEAL, LIP 10X25X7 |
| | | 1 | RING, RETAINING |
| | | 2 | SEAL, LIP 17X40X7 |
| | | 1 | SEAL, LIP 1.85X.32 |
| | | 1 | RING, RETAINING |
| | | 1 | RING, RETAINING .440 EXTERNAL |
| | | 1 | SEAL, LIP .98X1.85X.276 |
| | | 1 | RING, RETAINING |
| | | 2 | RING, RETAINING |
| | | 2 | SEAL, LIP 17X40X5 |
| 217 | 50928 | 1 | SEALANT |
| 218 | | 77oz | 20W-50 OIL |